

KEY CONTROL ROUND DEADBOLT - GCD9571

Box Pack Specifications

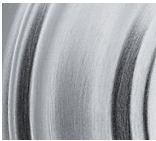

SATIN NICKEL



SATIN CHROME



GD9571	15 Satin Nickel	26D Satin Chrome
SmartKey Single Cylinder 20 Min	<input type="checkbox"/>	<input type="checkbox"/>
SmartKey Single Cylinder 3 Hr	<input type="checkbox"/>	<input type="checkbox"/>

SPECIFICATIONS



Door Prep	Cross Bore 2-1/8" Edge Bore 1" Latch Face 1" x 2-1/4"
Backset	Adjustable to 2-3/8" or 2-3/4"
Door Thickness	1-3/8" - 1-3/4" doors standard 2-1/4" doors optional
Cylinder	SmartKey
Faceplates	1" x 2 1/4" Includes square corner, radius corner and drive-in
Strikes	1-1/8" x 2-3/4" Includes square corner and radius corner
Bolt	1" throw. Steel
Door Handing	Reversible for right or left-handed doors
ANSI/BHMA	A156.5 Grade 2
ADA	Interior turn piece meets 4.13.9 ADA requirements
UL	Fire rating available, see specific product for availability
ASTM	All Weiser product meets ASTM E 331 water penetration testing

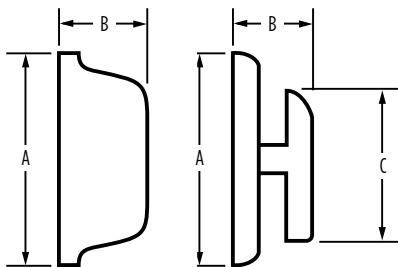

Dimensions	A	B	C
GCD9571 RDT Interior	2 ⁹ / ₁₆ "	1 ⁵ / ₁₆ "	1 ¹³ / ₁₆ "
GCD9571 RDT Exterior	2"	1 ⁵ / ₁₆ "	

WARRANTY:

Weiser™ products provide a "Lifetime Mechanical Warranty" that covers all defects in material and workmanship. For more information, please visit ca.weiserlock.com/en/warranty/.